

# 7750 Series

STAINLESS STEEL TUBE

These 316L stainless steel meters feature flange connections, all welded construction (no O-rings), and an end to end length of 250mm. A float and tapered tube design provides longer, more linear scales. A 4-20mA transmitter option adds to its versatility.



## DESCRIPTION

<b>Overall Length</b>	250 millimeters
<b>Metering Tube</b>	316L SS
<b>Internal Components</b>	316L SS
<b>Inlet/Outlet Fittings</b>	150# or 300# flange, vertical
<b>O-Ring</b>	All welded construction, no O-rings or gaskets
<b>Indicator Housing</b>	Die-cast Aluminum / Powder Coated with Chemfilm base (RoHS Compliant) Rated IP66 (Excludes Alarm and Transmitter Cases)
<b>Flange Material</b>	316L SS
<b>Scale</b>	120 mm direct reading, detachable

## PERFORMANCE

<b>Capacities</b>	Water 33 GPH to 16.5 GPM Air 2.2 SCFM to 76 SCFM												
<b>Scale</b>	120 mm direct reading, detachable												
<b>Accuracy</b>	± 3% of full scale flow												
<b>Turndown</b>	10:1												
<b>Repeatability</b>	1%												
<b>Maximum Temperature</b>	400° F (204° C)												
	<table border="1"> <thead> <tr> <th>Temp F</th> <th>150#</th> <th>300#</th> </tr> </thead> <tbody> <tr> <td>200°</td> <td>225 psi</td> <td>600 psi</td> </tr> <tr> <td>300°</td> <td>200 psi</td> <td>540 psi</td> </tr> <tr> <td>400°</td> <td>180 psi</td> <td>515 psi</td> </tr> </tbody> </table>	Temp F	150#	300#	200°	225 psi	600 psi	300°	200 psi	540 psi	400°	180 psi	515 psi
Temp F	150#	300#											
200°	225 psi	600 psi											
300°	200 psi	540 psi											
400°	180 psi	515 psi											
<b>Maximum Pressure</b>	See 150# and 300# SS flange class above												
<b>Ambient Temperature</b>	-40° F to 400° F (-40° C to 204° C)												

## OPTIONS

<b>Alarm</b>	Single or dual, Inductive Slot Sensor 4-20 mA transmitter (See page 62)
<b>Certified Calibrations</b>	Conform to ISA RP 16.6
<b>Scales</b>	Any volumetric unit

# 7750 Specifications

STAINLESS STEEL TUBE

Order Number	Full Scale Flow GPM-Water	Meter
706	33.0 GPH	½"
708	1.1 GPM	½"
710	2.0 GPM	½"
712	4.0 GPM	½"
716	5.0 GPM	1"
718	10.0 GPM	1"
720	16.5 GPM	1"

Order Number	Full Scale Flow SCFM - Air	Meter
705	2.2 SCFM	½"
707	4 SCFM	½"
709	8 SCFM	½"
711	16.5 SCFM	½"
715	20 SCFM	1"
717	42 SCFM	1"
719	76 SCFM	1"

## DIMENSION DIAGRAMS

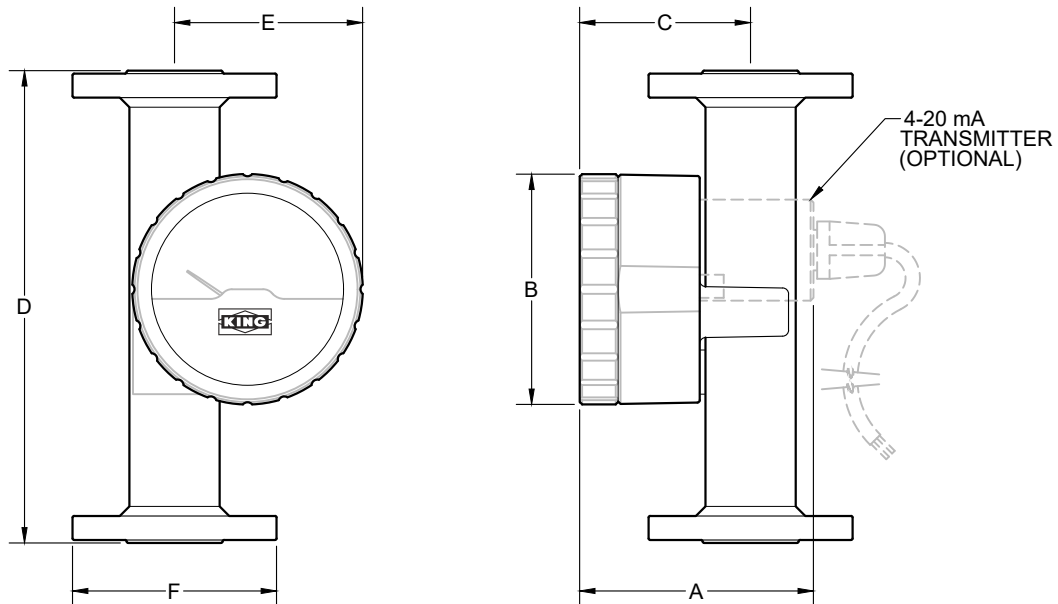

Water Order Number	Meter	Dimensions (Inches)					150 # Flange F	300 # Flange F
		A	B	C	D	E		
706 - 712	½"	4.87	4.80	3.27	9.84	3.67	3.50	3.75
716 - 720	1"	4.87	4.80	3.56	9.84	3.92	4.25	4.88

Air Order Number	Meter	Dimensions (Inches)					150 # Flange F	300 # Flange F
		A	B	C	D	E		
705 - 711	½"	4.87	4.80	3.27	9.84	3.67	3.50	3.75
715 - 719	1"	4.87	4.80	3.56	9.84	3.92	4.25	4.88

## ORDERING:

Use the following guide to determine the specific product number you require.

Meter Series	Connection Type	Float Material	O-Ring Material	Alarm/Transmitter	Order Number
7 7 5	150# R.F. Flanged - 2 300# R.F. Flanged - 3	316L SS - 2	No O-ring - 0	None - 0 With Transmitter - T One Alarm - A Two Alarms - D	See Specifications