

7310 Series

POLYSULFONE TUBE

An economical 304 stainless steel case with a molded polysulfone metering tube for lighter duty applications where a case enclosed meter is preferred.



DESCRIPTION

Metering Tube	Molded polysulfone
Internal Components	316L SS, Teflon®, PVDF Polysulfone or Hastelloy® C-276
Fitting Material	Standard: 316L SS Optional: PVC, PVDF
Inlet/Outlet Fittings	FNPT, vertical
O-Ring	Standard: Viton® Optional: Buna N, EPR, and Kalrez®
Case and Shield	304 SS case Polycarbonate shield

PERFORMANCE

Capacities	Water (PVDF float)	0.5 GPM
	Water (Teflon® float)	1 to 100 GPM
	Water (Metal float)	1.5 to 160 GPM
	Air	6.1 to 330 SCFM
Scale	127 mm (5") direct reading, detachable	
Accuracy	± 3% of full scale flow	
	± 5% of full scale flow (120 & 150 GPM Metal floats)	
	± 6% of full scale flow (Teflon® & PVDF floats)	
Turndown	10:1	
Repeatability	.5%	
	1% (120 & 150 GPM Metal floats)	
	1% (Teflon® & PVDF floats)	
Maximum Temperature	316L SS fittings	200° F (93° C)
	PVC fittings	130° F (54° C)
Maximum Pressure	316L SS fittings	200 psig
	PVC & PVDF fittings (sizes 41W to 72W)	150 psig
	PVC & PVDF fittings (sizes 90W to 103W)	125 psig
Ambient Temperature	33° F to 125° F (1° C to 52° C)	

OPTIONS

Alarm	Latching Reed Switch (Page 55)
Certified Calibrations	Conform to ISA RP 16.6
Scales	Any volumetric unit

FLOATS

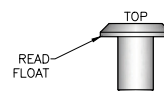

GV

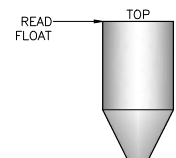

SL

7310 Specifications

POLYSULFONE TUBE

DIMENSIONS - WATER & AIR METERING

Order Number Water	Order Number Air	Dimensions (Inches)			
		A	B	C	D
41W - 46W	43A - 44A	12.875	4.625	4.50	9.58
51W - 56W	53A - 54A	12.875	4.625	4.50	9.58
61W - 72W	65A - 67A	12.875	4.625	4.50	9.58
90W - 103W	99A, 95A	16.000	6.250	6.25	13.25

DIMENSION DIAGRAMS

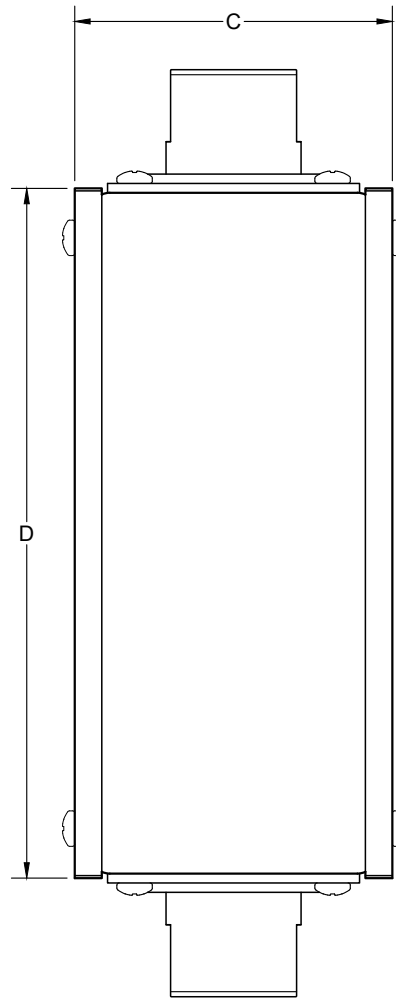
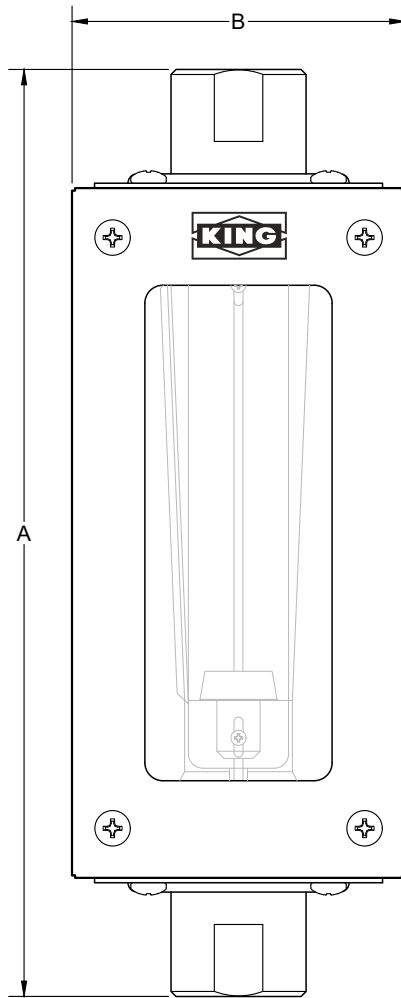

7310 Specifications

POLYSULFONE TUBE

SPECIFICATIONS – WATER

Order Number	Flow Range Water	Float Material	Float Number	Float Type	Alarm Option	Connect Size FNPT
41W	0.5 GPM	PVDF	4-TSL-01	SL	no	½"
42W	1 GPM	Teflon®	4-TSL-02	SL	yes	½"
43W	1.5 GPM	316L SS	4-SSL-01	SL	yes	½"
44W	3 GPM	316L SS	4-SSL-02	SL	yes	½"
45W	1.6 GPM	Hastelloy®	4-HSL-01	SL	yes	½"
46W	3.2 GPM	Hastelloy®	4-HSL-02	SL	yes	½"
51W	2.4 GPM	Teflon®	5-TSL-01	SL	yes	¾"
52W	5 GPM	Teflon®	5-TSL-02	SL	yes	¾"
53W	6 GPM	316L SS	5-SSL-01	SL	yes	¾"
54W	10 GPM	316L SS	5-SSL-02	SL	yes	¾"
55W	6.3 GPM	Hastelloy®	5-HSL-01	SL	yes	¾"
56W	10.6 GPM	Hastelloy®	5-HSL-02	SL	yes	¾"
61W	7.6 GPM	Teflon®	6-TSL-01	SL	yes	1"
62W	10 GPM	Teflon®	6-TSL-02	SL	yes	1"
63W	15 GPM	Teflon®	6-TSL-03	SL	yes	1"
64W	20 GPM	Teflon®	6-TSL-04	SL	yes	1"
65W	12 GPM	316L SS	6-GVL-01	GV	yes	1"
66W	18 GPM	316L SS	6-SSL-02	SL	yes	1"
67W	25 GPM	316L SS	6-SSL-03	SL	yes	1"
68W	35 GPM	316L SS	6-SSL-04	SL	yes	1"
69W	13 GPM	Hastelloy®	6-HSL-01	SL	yes	1"
70W	19 GPM	Hastelloy®	6-HSL-02	SL	yes	1"
71W	26.5 GPM	Hastelloy®	6-HSL-03	SL	yes	1"
72W	37 GPM	Hastelloy®	6-HSL-04	SL	yes	1"
90W	40 GPM	Teflon®	9-TSL-00	SL	yes	2"
91W	60 GPM	Teflon®	9-TSL-01	SL	yes	2"
92W	80 GPM	Teflon®	9-TSL-02	SL	yes	2"
94W	100 GPM	Teflon®	9-TSL-04	SL	yes	2"
99W	60 GPM	316L SS	9-SSL-00	SL	yes	2"
95W	80 GPM	316L SS	9-SSL-01	SL	yes	2"
96W	100 GPM	316L SS	9-SSL-02	SL	yes	2"
97W	120 GPM	316L SS	9-SSL-03	SL	yes	2"
98W	150 GPM	316L SS	9-SSL-04	SL	yes	2"
100W	84 GPM	Hastelloy®	9-HSL-01	SL	yes	2"
101W	106 GPM	Hastelloy®	9-HSL-02	SL	yes	2"
102W	126 GPM	Hastelloy®	9-HSL-03	SL	yes	2"
103W	160 GPM	Hastelloy®	9-HSL-04	SL	yes	2"

SPECIFICATIONS – AIR

Order Number	Flow Range Air	Float Material	Float Number	Float Type	Alarm Option	Connect Size FNPT
43A	6.1 SCFM	316L SS	4-SSL-01	SL	yes	½"
44A	12.4 SCFM	316L SS	4-SSL-02	SL	yes	½"
53A	25 SCFM	316L SS	5-SSL-01	SL	no	¾"
54A	41 SCFM	316L SS	5-SSL-02	SL	yes	¾"
65A	50 SCFM	316L SS	6-GVL-01	GV	yes	1"
66A	76 SCFM	316L SS	6-SSL-02	SL	yes	1"
67A	100 SCFM	316L SS	6-SSL-03	SL	yes	1"
99A	245 SCFM	316L SS	9-SSL-00	SL	yes	2"
95A	330 SCFM	316L SS	9-SSL-01	SL	yes	2"

ORDERING:

Use the following guide to determine the specific product number you require.

7	3	1	1																
---	---	---	---	--	--	--	--	--	--	--	--	--	--	--	--	--	--	--	--

Meter Series

Fitting Material

Float Material

O-ring Material

Alarm*

Order Number

316L SS - 2
PVC* - 3
PVDF* - 7

316L SS - 2
Hastelloy® C-276 - 4
Teflon® - 6
PVDF - 7

EPR - 1
Buna-N - 2
Viton® - 3
Kalrez® - 4

No Alarm - 0
With Alarm - A

See Specification above

* Not for air service.

Teflon® is a registered trademark of the Chemours Company

* FLOW RATES MAY VARY FOR METER WITH ALARMS AND TEFLON FLOATS